

James Irwine and—M^cElree.

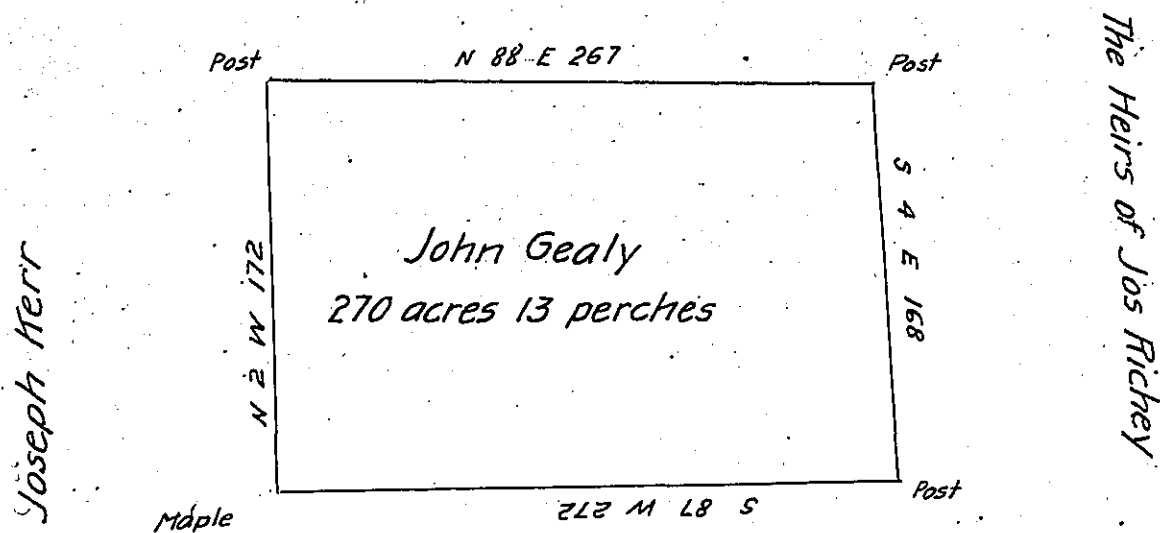

The Heirs of John Burnside

Situate in Wolf Creek Township Mercer County Survey-
 ed November 12th 1838 at the request of John Gealy and in persuent
 of an actual settlement made fourty years since the Survey Contains
 270 acres 13 perches and usual allowance &c.

February 23^d 1839

B. Alexander D.S.

John Taylor Esqr. S.G.

IN TESTIMONY that the above is a copy of the original remaining on file in
 the Department of Internal Affairs of Pennsylvania, made
 conformably to an Act of Assembly approved the 16th day of
 February, 1833, I have hereunto set my Hand and caused
 the Seal of said Department to be affixed at Harrisburg,
 this ninth day of February 1905

Loae D. [Signature]
 Secretary of Internal Affairs.